

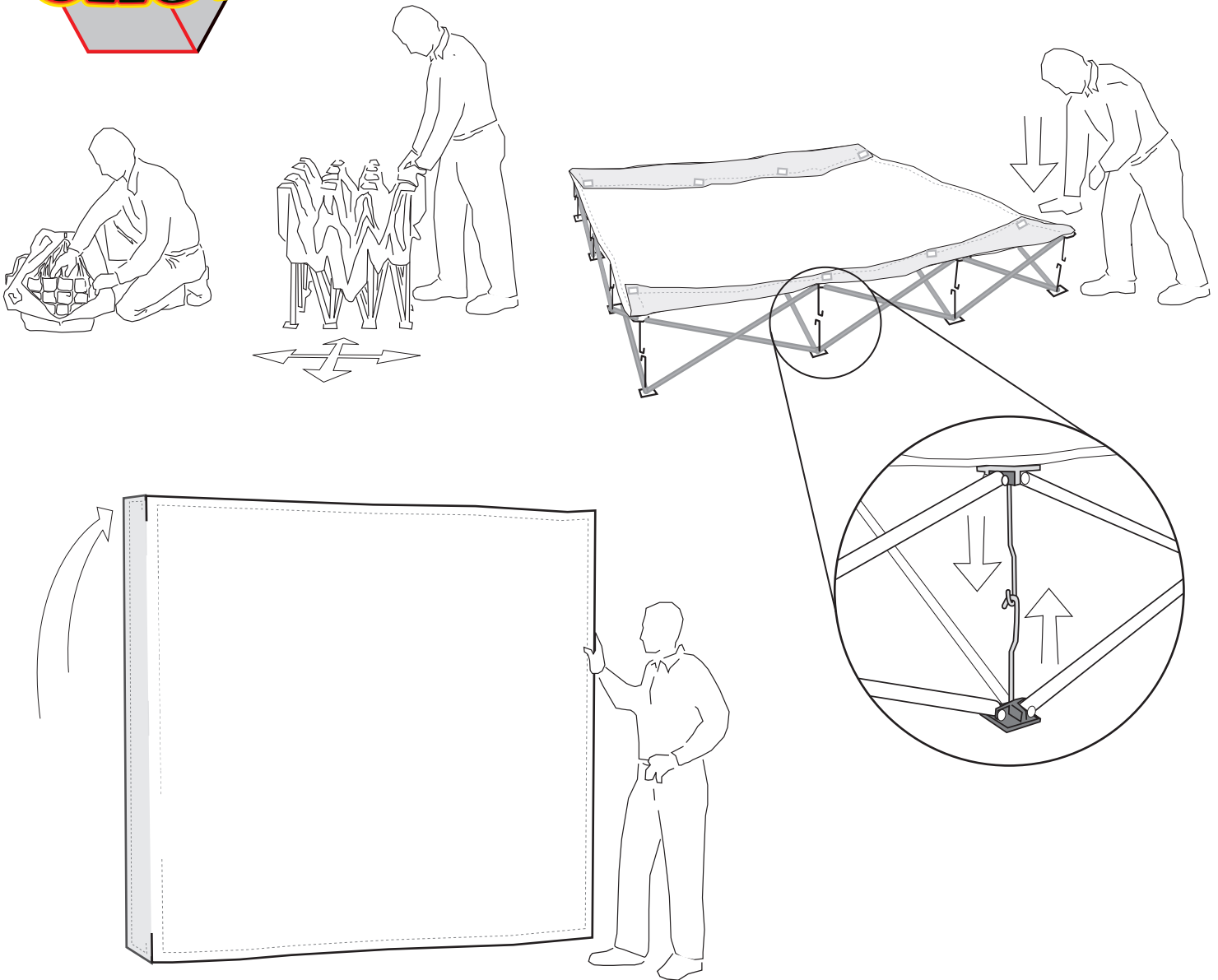

## Set-up Instructions

DISPLAYS | area  
by | EXHIBITS



### Set-up Instructions

For table top or standing backwall (shown)

1. Spread collapsed display out in all four directions - fabric graphic facing up
2. Connect apposing J-hooks around perimeter of display
3. Stand display up and connect remaining center J-hooks from behind
4. Velcro attach side graphic flaps to back hubs of display
5. To break down repeat steps in reverse

Make Sure All J-hooks Are Disengaged Before Collapsing Display



# WARNING

## AVOID DAMAGE!

Make Sure to Unhook ALL "J" Hooks Before Collapsing Frame!

**ANY RESISTANCE STOP!**

Two "J" HOOKS Are Still connected.

**ALL HOOKS MUST BE DISENGAGED BEFORE CLOSING FRAME.  
FAILURE TO DO SO WILL DAMAGE THE FRAME.**

---

A

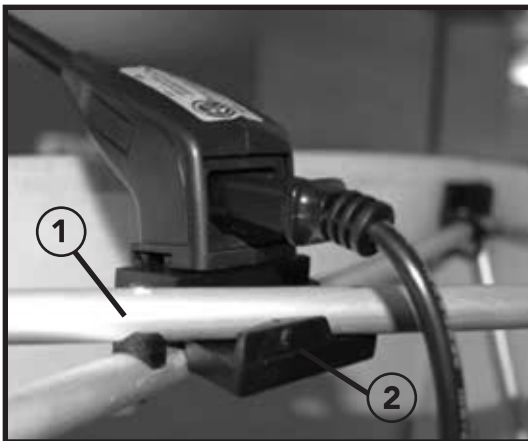

B



C

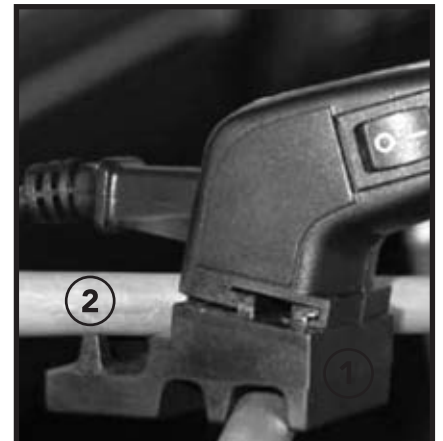

(A) VBurst lights fit within the front and back Quad scissors at the top of the display. The grooves in the base of the light **1** fit onto the scissor bars **2**. The front of the base sits over the front bar and the back of the base sits underneath the back bar. Start by feeding the base in from the front of the display by tilting slightly then lowering the base into place.

(B) From the back you can see how the base of the light fits over and under the scissor bars. Also, the power plug drapes over the back bar to the outlet.

(C) The side view shows again how the base of the light **1** rests on the front and back scissor bars **2**. You can also see the power switch that is located on the side. Plug the lights in then switch them on.